

BRUCHA[®] Paneel

PUR/PIR roof light – DP-L

Minimum roof pitch 5° (8.6%)

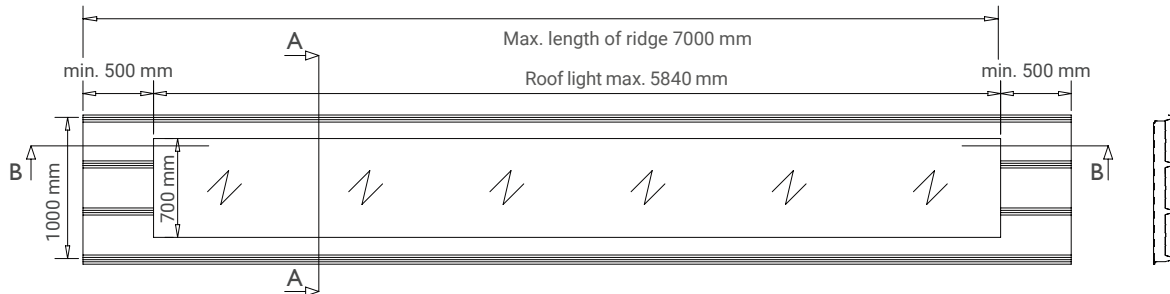

System cross-section A-A –
transverse

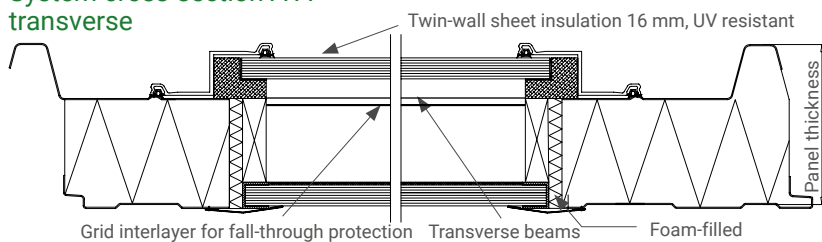

System cross-section B-B –
longitudinal

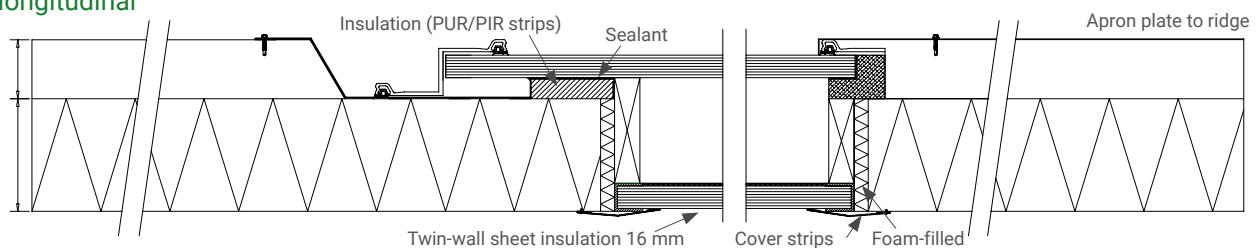

We will be happy to send certificates on request!

BRUCHAPaneel®

PUR/PIR roof light – DP-L

Minimum roof pitch 5° (8.6%)

- Installation without system change of the BRUCHAPaneel PUR/PIR roof – DP is possible.
- No additional substructure necessary.
- Multiple roof lights can be installed adjacent to one another.
- High strength thanks to double-skin multi-wall light elements made from polycarbonate.
- Grid interlayer for fall-through protection.
- Evidence of load capacity - spot loading max. 4.5 KN (including reduction), accessibility test - for DP-L 142 TU Darmstadt (IFSW) - PB 18/18p
- Light transmission 70%, UV resistant.
- Including apron plate on ridge side.
- Outstanding insulation characteristics.
- Fire behaviour in accordance with EN 13501-1, Euroclass B, flame-retardant.



Planungsraster: 1000 mm



Panel type	DP-L 82	DP-L 102	DP-L 122	DP-L 142	DP-L 162	DP-L 182	DP-L 202
Core thickness mm	40	60	80	100	120	140	160
U-value W/m ² K*	~0.81	~0.73	~0.73	~0.64	~0.64	~0.64	~0.64

*U-values are calculated mathematically and are approximate.

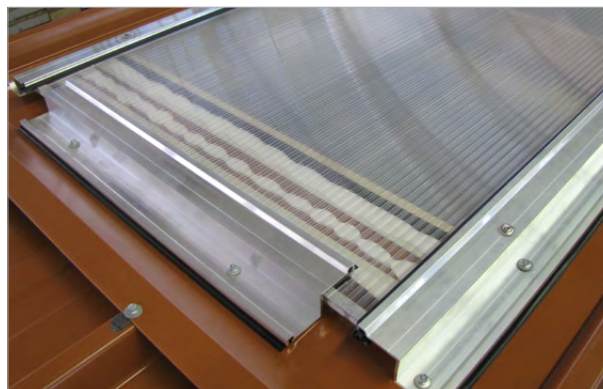
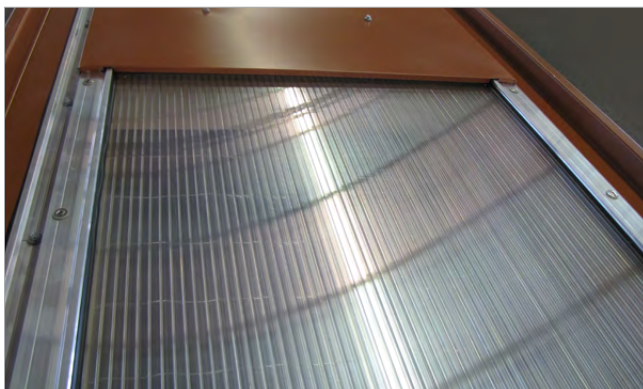

DP-L without approval for Germany