



## Ostflex High Performance Flexible Waterproofing

Ostflex High Performance Flexible Waterproofing membranes have been specially developed to achieve a durable, sustainable, flexible and environmentally friendly waterproofing solution.



[www.ostmanthermal.com](http://www.ostmanthermal.com)  
[ostflex@ostmanthermal.com](mailto:ostflex@ostmanthermal.com)

## OSB

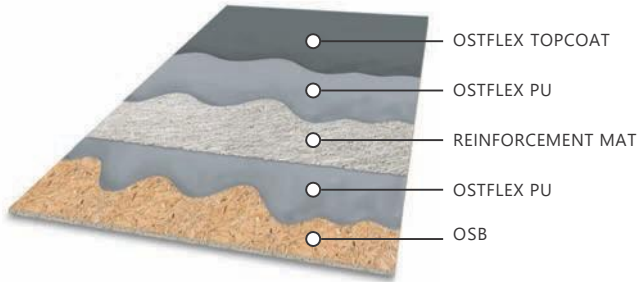

## WARM ROOF

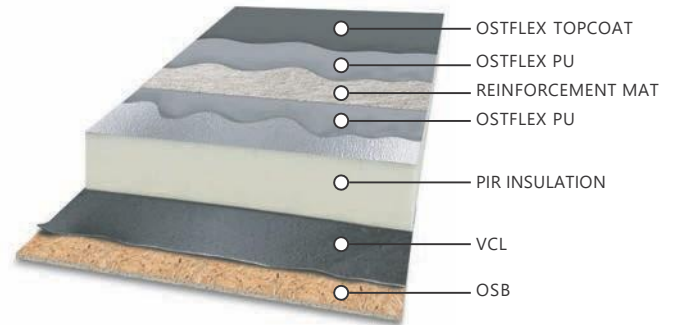

## OVERLAY

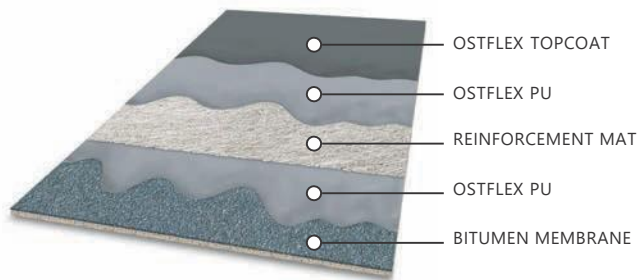

## CORRUGATED

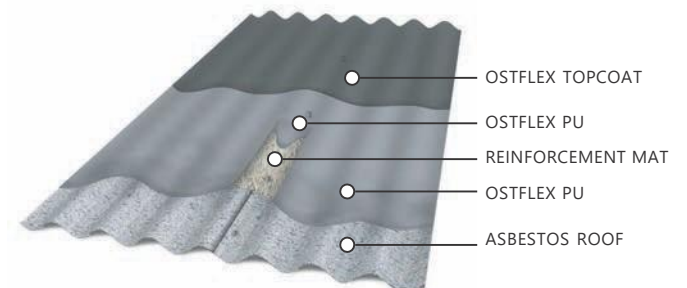

## CONCRETE

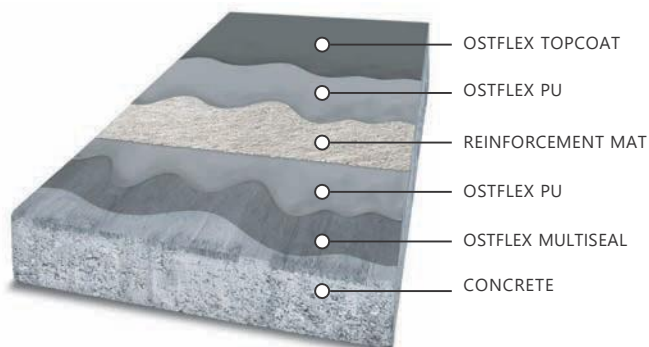

## GREEN

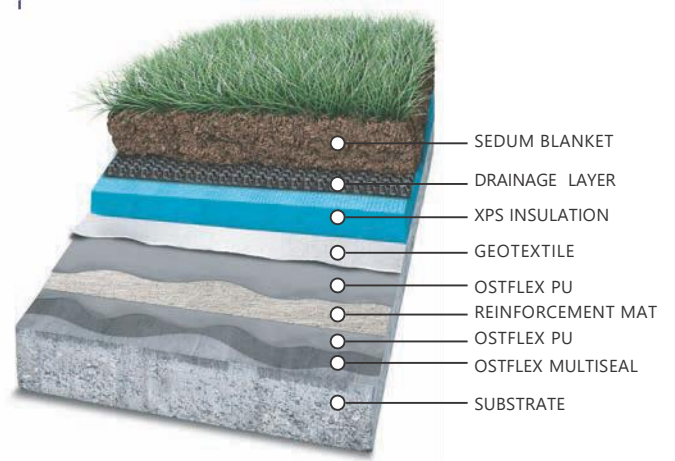

# BENEFITS



 <p>Provides long term UV resistance.</p>	 <p><b>FIRE RESISTANCE</b> Ostflex membranes hold Broof T4 fire classification.</p>	 <p><b>ALL YEAR</b> Ostflex can be installed all year.</p>	 <p><b>NHBC</b> Approved for NHBC projects.</p>		
 <p><b>SUSTAINABILITY</b> Certified Lifespan in excess of 25 years.</p>	 <p><b>GUARANTEES</b> Available for 15, 20 and 25 years.</p>				
 <p><b>EXCELLENT ADHESION</b> Excellent bonding to most roofing substrates.</p>	 <p><b>ENVIRONMENTALLY FRIENDLY</b> Ostflex respects the environment during production and installation.</p>				
 <p><b>SAFE APPLICATION</b> No naked flames required.</p>	 <p><b>TRAFFICABLE</b> Allows pedestrian traffic once cured.</p>				
 <p><b>AESTHETICS</b> Ostflex provides a modern and aesthetically pleasing roof finish.</p>	 <p><b>TECHNICAL SUPPORT</b> Technical reports and CAD drawings available.</p>			 <p><b>CERTIFICATIONS</b> Certified to the highest standards and BBA approval.</p>	 <p><b>CERTIFICATIONS</b> Certified for green roofs</p>

## PRODUCT RANGE

PRODUCT	DESCRIPTION	KG/LTRS	COVERAGE	DRYING TIME
<b>OSTFLEX PU</b>	Liquid membrane	15kg drums 60 drums per pallet	8-10m <sup>2</sup>	2-6 hours <i>*depending on temperature and humidity. Fully cured in 24hrs</i>
<b>OSTFLEX MULTISEAL</b>	Clear membrane as sealing coat or primer	5Ltrs	10-30m <sup>2</sup> <i>*depending on application</i>	2 – 4 hours
<b>OSTFLEX TOPCOAT</b>	UV resistant topcoat	5Ltrs	20-30m <sup>2</sup>	1 - 2 hours
<b>OSTFLEX MATT</b>	Reinforcing matting	----	20x1 m <sup>2</sup> 60x1 m <sup>2</sup>	----

STORAGE 5-25C-protect from frost and direct sunlight

Also available other sizes

## APPLICATION GUIDE

- Check the substrate is clean and in good condition.
- Application temperature must be between 5 – 35C.
- All trims must be fixed prior to Ostflex application.
- Use a PU sealant to seal any cracks or gaps.
- Open the drum and stir before applying Ostflex.
- If product is left to stand on site, stir again before application.
- Apply Ostflex liquid as described below, first to details and perimeters and then to the flat area.
- Apply Ostflex liquid wet-on-wet by applying a generous coat of liquid first, then dry rolling the matting onto the liquid and finally applying more liquid on top to achieve the required thickness. Ensure the matting is fully encapsulated without pinholes or tenting.
- At this stage the roof is watertight and will resist rain.
- Typical coverage is 8-10 sqm per drum although this may vary depending on substrate.
- After applying the waterproofing layer check for pinholes or any dry areas that may require more liquid.
- Once the Ostflex membrane is dry, apply a layer of Ostflex Protect Topcoat within 48 hours.
- Check the full application sheet for specific substrates and systems.

## USE OF OSTFLEX PRIMER

<input checked="" type="checkbox"/> CONCRETE	<input checked="" type="checkbox"/> TPO SINGLE PLY	<input checked="" type="checkbox"/> OSB/PLYWOOD
<input checked="" type="checkbox"/> ASBESTOS	<input checked="" type="checkbox"/> EPDM MEMBRANE	<input checked="" type="checkbox"/> METAL
<input checked="" type="checkbox"/> BITUMEN MEMBRANE	<input checked="" type="checkbox"/> ASPHALT	<input checked="" type="checkbox"/> PVC SINGLE PLY